

Spring/Cable Assembly Installation

- 1) Slide a spring/cable assembly into housings A & B, so that the springs are at the end of housing B and the cable is coming out of Housing A's angled end.
- 2) ***IMPORTANT: Make sure to use the same spring combination that was previously installed, cutting out the springs you're not using with bolt cutters.***

Insert a 1/2-inch clevis pin into the rear hole of housing B; then run it through the looped ends of your springs and out the other side of the housing.

Slide a 1/2-inch flat washer onto the clevis pin; then by using needle nose pliers and a gentle rocking motion, secure the clevis pin with a 1/2-inch locking ring.

Reverse the position of the two loose ends of the locking ring to lock it securely in place. See Figure 1.

- 3) Repeat steps 1 through 3 to install the other spring/cable assembly.

FIGURE 1, locking ring assembly

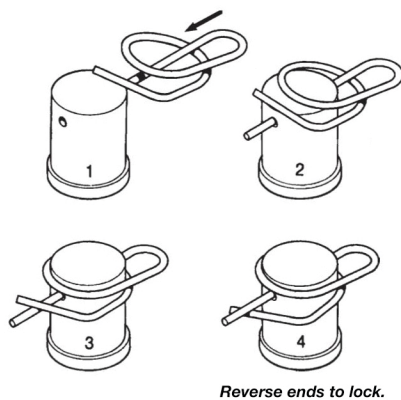

FIGURE 2, housing and roller assembly

